

PowerPatch Manual 10000mAh Powerbank

AC Plug/Built-in-charging cable

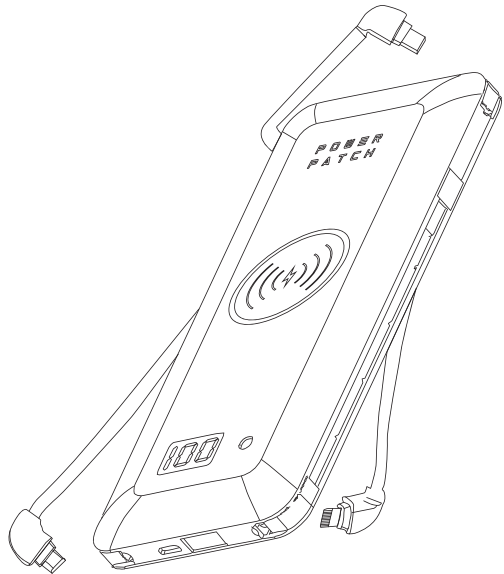

Please read to its entirely prior to use

Description

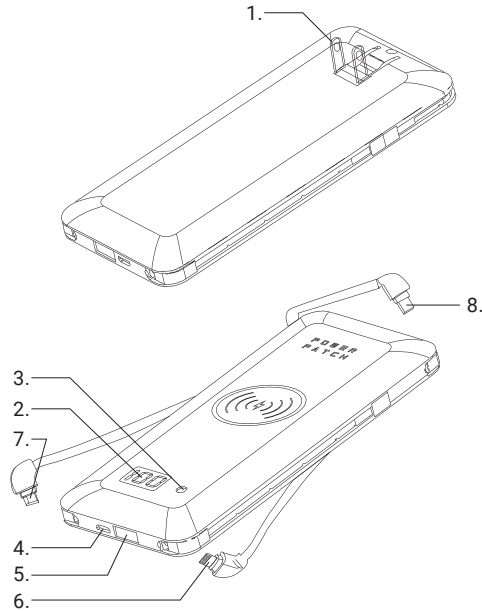

1. AC Plug
2. Power indicator
3. Power button
4. Micro USB input port
5. USB output port
6. Built-in output cable 1.
7. Built-in output cable 2.
8. Built-in output cable 3.

Specifications

1. Capacity: 3.7V-10000mAh 37Wh
2. AC input: 110-240V-0.15A 50/60 Hz
3. Cable output: 5V-2.1A(max.)
4. Wireless output: 5W
5. Micro USB input: 5V-2A(max.)
6. CAUTION: Do not open, Crush Heat is Above 65 or it Incinerates. Follow Manufacturer's Instructions.

Compatible with

Tablet, Mobile Phone, Smart Phone, Smart Watch, Gaming Console, Music Device, etc

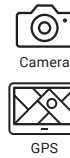

Camera



MP3/MP4



Smartwatch



GPS



Mobile



Tablet

Note: Must be a 5V Device

Operating Instructions

Turning the PowerPatch On/Off

Quickly press the power button to turn on the power bank.
Charging begins automatically after connecting your device.
The digital screen will illuminate to show the battery capacity rate while charging your device.
If no device is being charged, the display and PowerPatch will turn off automatically after a few seconds.

Charging Your Device

Option 1:

Ensure the PowerPatch is turned on.
Your device will automatically charge when connected to 1 of the 3 built-in charging cables.
If not charging, press the power button to check the power percentage remaining in the bank.

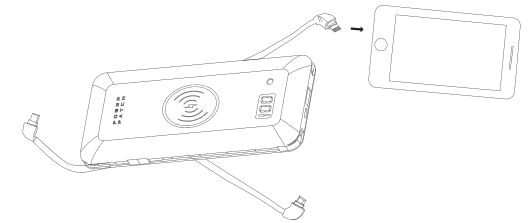

Option 2:

Wireless Charging
Ensure the PowerPatch has remaining power.
If your device supports wireless charging, place your device close to the wireless charging icon of the PowerPatch and charging will begin automatically.

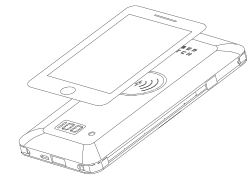

Option 3:

USB Charging

Ensure the PowerPatch is turned on. Connect your USB cable to the bank's USB port. Then connect the cable to your phone. Charging will begin automatically.

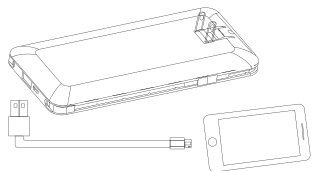

Charging the PowerPatch

Option 1:

To charge the PowerPatch, plug unit directly into an AC outlet using the built-in AC plug. The Digital LED display indicates the battery level and reads '100%' once fully charged. It takes about 8 hours to fully charge the power bank from an AC outlet.

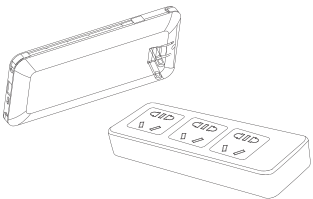

Option 2:

To charge via USB, use the supplied Micro USB cable and connect the PowerPatch to an AC powered USB adaptor. The LED Digital display indicates the battery level and reads '100%' once fully charged.

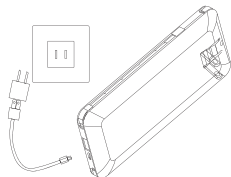

Note: The PowerPatch charges at a standard charging speed.

Check the Battery Power Level

Press the power button to turn on the LED digital screen. You can then read the Battery Power Level. The digital display shows battery levels from 0% to 100%.

Note

- While charging the PowerPatch, warming of its surface is normal. Please do not cover the battery bank during charging. Do not charge it in a high environmental temperature.
- If any visible physical damage has occurred, do not use the PowerPatch anymore.

Important Safety Instructions

WARNING- When using this product, follow basic precautions, including the following:

- Read all the instructions before using the product.
- Close supervision is necessary when the PowerPatch is being used near children to reduce the risk of injury.
- Do not place your fingers or hand inside the product.
- Do not expose the PowerPatch to rain or snow.
- Use of a charger or power supply charger not sold or recommended by PowerPatch manufacturer may result in the risk of fire or injury to persons.
- Do not use the power bank in excess of its output rate. Overloading outputs above the total rate may result in the risk of fire or injury to persons.
- Do not use if the PowerPatch is damaged or modified. Damaged or modified batteries may exhibit unpredictable behavior resulting in fire, explosion, or risk of injury.
- Do not disassemble the PowerPatch. When service or repair is required, take the battery bank to a qualified service representative. Incorrect reassembly may result in the risk of a fire or injury to persons.
- Do not expose the PowerPatch to fire or excessive temperatures. Exposure to fire or temperatures above 212°F may cause explosion.
- Have servicing performed by a qualified representative using only identical replacement parts. This will ensure that the safety of the product is maintained.

SAVE THESE INSTRUCTIONS
Conforms to UL Subject Std. 2056

Caution

Dispose of used lithium batteries according to the instructions below. There is a risk of explosion if the lithium battery is replaced by an incorrect type:

- The lithium battery should not be exposed to excessive heat such as sun or fire, that can result in an explosion or the leakage of flammable liquid or gas.
- The device should not be exposed to dripping or splashing, nor objects filled with liquids- such as vases-should be placed on top of the device.
- Avoid removal or replacement of the battery with an incorrect type that will jeopardize the safety of using this product. Please contact a local recycling facility.
- Do not dispose the battery into a fire or a hot oven. Do not mechanically crush or cut the battery, this may result in an explosion.
- Avoid subjecting the battery to extremely low air pressure, this may result in an explosion or the leakage of flammable liquid or gas.
- The embedded and non-replaceable battery is designed to last the lifetime of the PowerPatch.



Do not dispose of lithium battery with general waste. Please return it to battery recycling collection point.



RoHS



Made in China