

## Warning

- **Do NOT** rub any attachments on the same area for a long duration of time.
- **Do NOT** apply strong pressure.
- **The unit is NOT waterproof.** Never use the unit if it has been submerged in water.
- Use Naked Nails only for the purposes described in this Instruction Manual.
- Do not expose Naked Nails to excess moisture.
- For hygienic reasons, the head/attachments should not be shared with others.
- Do not use Naked Nails if you have diabetes, poor blood circulation, finger-nail breakage, infection, or ringworm.
- Do not use near open wounds.
- If you have any skin conditions or medical issues, please consult your physician before use.
- Discontinue use immediately if you experience any pain or irritation.
- Not for use with children under 12 years old or anyone with diminished mental capabilities without adult supervision.
- Store in a cool dry place. Do not store in direct sunlight.
- Do not turn unit on without one of the attachments in place.
- Do not insert/drop anything into any of the openings of the unit.
- When in use, keep Naked Nails away from hair, scalp, eyebrows, and eyelashes.
- Keep protective cover on when not in use.
- Do not mix alkaline, carbon-zinc, or rechargeable batteries.
- Do not mix old and new batteries.

# Naked NAILS

by FINISHING Touch.

Fast & Easy Way to Beautiful Nails!

## Instruction Guide

Thank you for your purchase of **Naked Nails™** –  
the electronic manicure tool  
for natural, shiny nails in seconds.

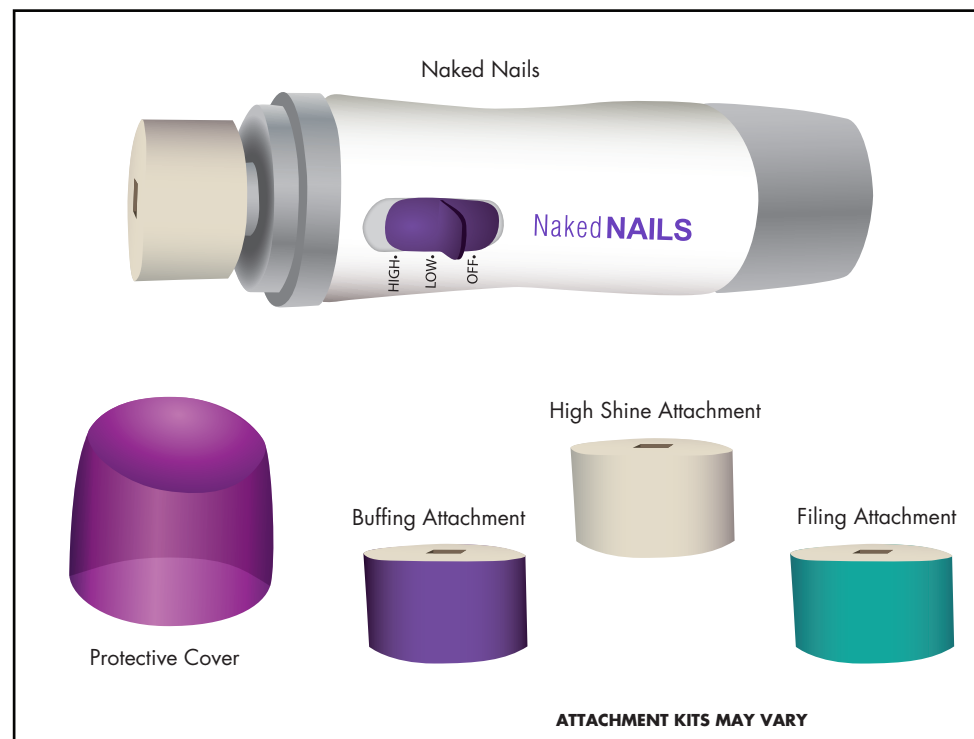

**IMPORTANT:** Read all instructions and warnings prior to use.

- You should only use the Buffing attachment on your nails once every two weeks.
- Lightly glide the Buffing and High Shine rollers over nail surface for 1-2 seconds. Do not over use product on nail surface.
- If your nails are brittle, we recommend using only once a month.
- Consult your physician prior to use if you have any nail or skin conditions.

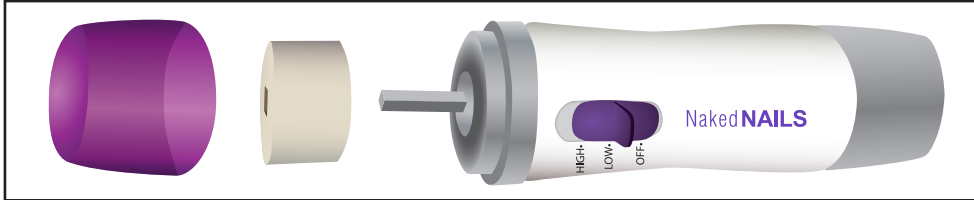

## GETTING STARTED

Prior to your first use, test Naked Nails on a small area on one of your nails. If there is a sensitive reaction, discontinue use immediately. Use on nails only – do not use on other body parts.

### Inserting Batteries

- Unscrew battery compartment cover located at the bottom of the unit (image 1).
- Slide battery holder out (image 2) and insert two AA batteries (image 3) into the holder following +/- indicators.
- Slide battery holder back into handle, following the arrow indicator.
- Once batteries are correctly inserted, replace the battery cover on the unit.

**NOTE:** Only use new batteries of the same brand. Do not mix alkaline, carbon-zinc, or rechargeable batteries. Do not mix old and new batteries. Make sure the battery is inserted in the proper direction on the battery holder. If the unit is not used for a long period of time, remove the batteries from the unit. Discard batteries according to the recycle regulations in your community. If the batteries are placed in the unit incorrectly, the unit will not work.

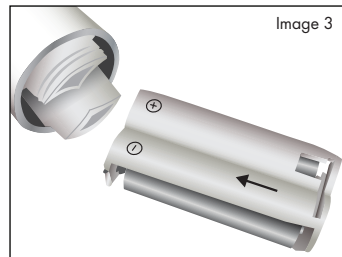
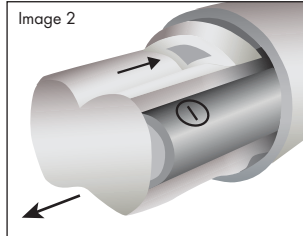
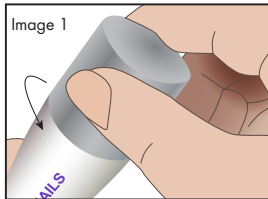

## How to Clean

**Do not expose Naked Nails to water or excess moisture.** For best performance, clean Naked Nails after each use. Make sure the unit is turned off; lift the cover and attachment from the unit. Remove debris with a soft, dry cloth or towel. Wipe the body with a clean dry cloth and replace attachment/cover.

## How to Use

Use only on dry nails. For best results, make sure nails are clean.

1. Remove the clear protective cover from the attachment before first use (image 4).
2. Select the cylindrical foam attachment you want and make sure it is firmly attached before using.
3. Turn the unit on by sliding the Power Switch located on the side of the unit to LOW or HIGH (image 5).
4. Lightly glide the selected attachment over the nail for 1 – 2 seconds at a time (image 6). Do not apply pressure.

• AQUA – Files the nail

• PURPLE – Buffs ridges and imperfections on nail surface

• WHITE – Shines nails

5. When finished with each attachment, rinse and dry nails thoroughly to get rid of any debris.

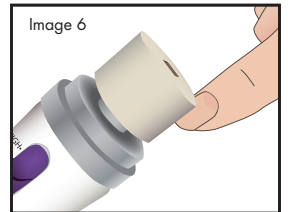
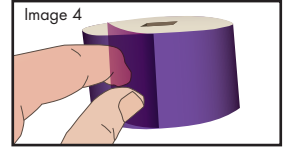

## Replacing the Attachments

Replace the foam cylindrical attachments as needed for best results. Attachments last through several sessions depending on frequency of use and size of area.

- Make sure the unit is turned off.
- Pull the attachment off the top of the unit (image 7).
- Place a new attachment onto the head and press down firmly (image 8).
- Check that the new attachment is firmly in place (not loose or shaky) before turning the unit on.

**Attachments that are nicked, worn, or broken could cause damage to nails and should be replaced.**

