



**ELECTRIC VEGETABLE SLICER
INSTRUCTION MANUAL
MODEL GS906CT**

IMPORTANT SAFEGUARDS

When using electrical appliances, basic safety precautions should be followed as follows:

- Read all the instructions.
- Intended for household use only.
- Do not use the appliance for anything other than intended use.
- Do not operate this unit in the presence of explosives and/or flammable fumes.
- Remove the unit and the instruction manual from the box and remove all packing materials.
- Do not leave the appliance unattended during operation. Close supervision is necessary when any appliance is used by or near children to avoid injury to themselves or others.
- Do not operate any appliance with a damaged cord or plug, or after the appliance malfunctions or has been damaged in any manner.
- Do not place the unit on or near gas or electric cooktops or in a heated oven to avoid damage.
- Use only replacement parts provided by the manufacturer.
- To protect against electrical shock, do not immerse power cord, plugs, or the whole unit in water or any other liquid.
- Always unplug from the wall outlet first.
- The use of an extension cord is not recommended.

- Place the unit on a level surface away from walls and cupboards. Do not let the cord hang over the edge of a table or counter, or come into contact with hot surfaces.
- Unplug the unit when not in use and before cleaning.
- Make sure the unit is unplugged before moving the unit.
- The blades are extremely sharp, handle with care.
- Keep hands and utensils out of the unit while in use to prevent personal injury or damage to the unit.
- Always store drums properly to avoid damage or personal injury.
- Avoid contact with all moving parts.
- Do not attempt to remove the blade until it has stopped rotating.
- Do not use outdoors.
- SAVE THESE INSTRUCTIONS.

PARTS IDENTIFICATION

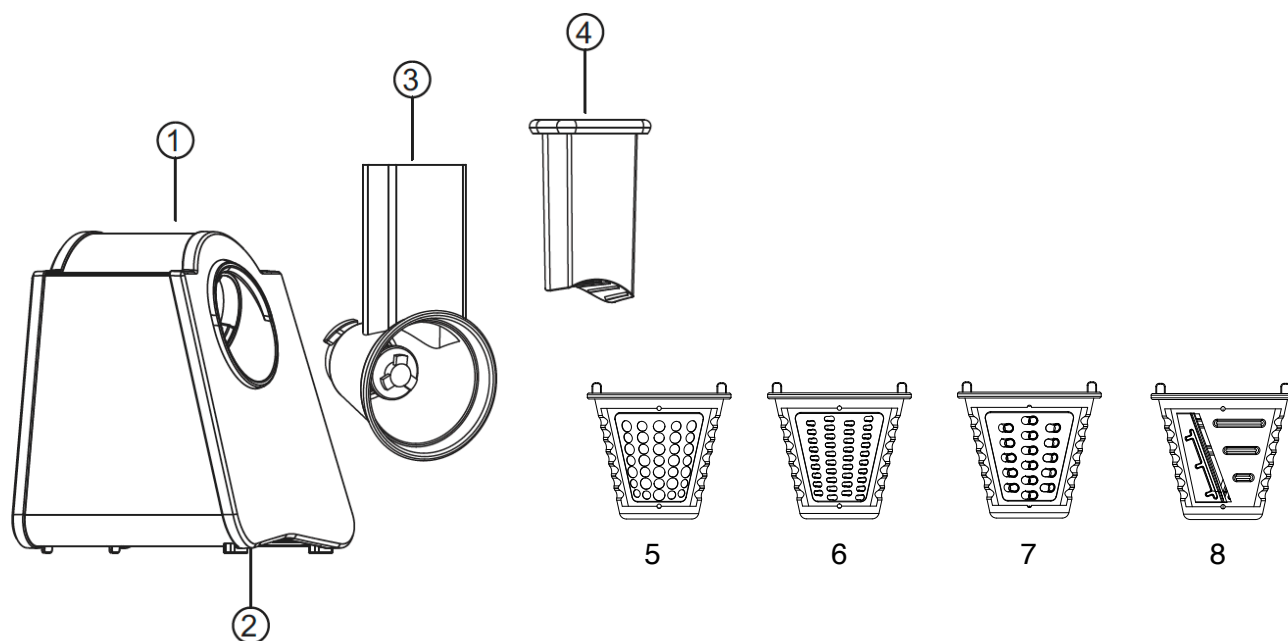

1. Switch Button
2. Bottom Base
3. Feeding Tube

4. Food Pusher
5. Grinder Drum
6. Fine Shredding Drum

7. Rough Shredding Drum
8. Slicing Drum

DRUM USES *Do not run the machine for more than 2 minutes in a cycle*

Grinder Drum- This drum should be used for grinding and grating hard cheese, chocolate, almonds.

Fine Shredding Drum- This drum should be used for fine grating of carrots, hard cheese, chocolate.

Rough Shredding Drum- This drum should be used for the coarse grating of carrots, potatoes, peppers, hard cheese or chocolate.

Slicing Drum- This drum should be used for cutting smooth slices of carrots, potatoes, cucumbers, peppers, onions, apple, hard cheese, cabbage.

BEFORE FIRST USE

1. Remove all packaging materials.
2. See page 6 for care instructions and clean before use.
3. Wipe the inside and outside of the appliance with a cloth.

USING THE APPLIANCE

1. To lock the feeding tube in place turn counterclockwise on the unit then place the desired drum in the feeding tube. (Seen photo below) Place a bowl underneath to catch the food.

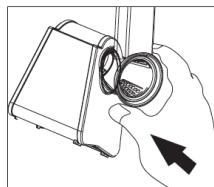

2. Plug the unit into the wall socket.
3. Begin processing by putting food into the feeding tube and pressing the power button, always use the food pusher, never use your hands.

NOTE: If the drums become clogged during use, take the drum out and clean it then continue processing.

4. Once finished, unplug and clean after each use.

CLEANING

Clean after every use.

1. Before cleaning unplug the unit. Turn the feeding tube clockwise to open and clean.
2. Wash parts by cleaning with hot water and dish liquid, allow to dry thoroughly before storing. Do not immerse in water or place in the dishwasher.
CAUTION: Drums are extremely sharp.
3. Wipe the external surface of the base with a soft damp cloth and dry surfaces with soft dry cloth. Do not use any abrasive detergent as this may scratch the outside.
4. Once all parts are dry place in a dry place.

Note: Never immerse the base housing in water.

Problem	Solution
The machine stops working.	<ul style="list-style-type: none"> - Check and ensure that the appliance is properly connected to the wall outlet and that power is switched on at the outlet.
The machine stops working or becomes over heated.	<ul style="list-style-type: none"> - Excessive food is processing or pushing the food too hard. Do not exceed the feeding tube height.
The drums become blocked.	<ul style="list-style-type: none"> - The food is too hard to be sliced. Cut the food into smaller pieces.

TROUBLE SHOOTING

LIMITED ONE YEAR WARRANTY

This warranty covers all defects in workmanship or materials in the mechanical and electrical parts arising under normal use and care in this product for a period of 12 months from the date of purchase provided you are able to present a valid proof-of-purchase. A valid proof-of-purchase is a receipt specifying item, date purchased, and cost of item. A gift receipt showing item and date of purchase is an acceptable proof-of-purchase. Product is intended for household use only. Any commercial use voids the warranty.

This warranty covers the original retail purchaser or gift recipient. During the applicable warranty period within normal household use, we will repair or replace, at our discretion, any mechanical or electrical part which proves defective, or replace unit with a comparable model. Shipping and handling costs are not included for warranty replacements and are the responsibility of the customer.

To obtain service under the terms of this warranty, call our customer care department at 312-526-3760 (Monday- Friday 10:00AM-4:00PM CST), or send an email to customercare@alliedrich.net. Please provide the model number listed on the bottom of this page when contacting us.

THIS LIMITED WARRANTY COVERS UNITS PURCHASED AND USED WITHIN THE UNITED STATES AND DOES NOT COVER:

- Damages from improper installation.
- Damages in transit.
- Defects other than manufacturing defects.
- Damages from misuse, abuse, accident, alteration, lack of proper care and maintenance, or incorrect current or voltage.
- Damage from service by other than authorized dealer or service center.
- Shipping and handling costs.
- This warranty gives you special legal rights and you may also have other rights to which you are entitled which may vary from state to state.

Manufacturer does not assume responsibility for loss or damage for return shipment. We recommend that you keep your original packaging should you require repair service. Before returning product please contact our customer care department for return authorization. When returning product for repair please include your full name, return address, and daytime phone number. Also include a brief description of the problem you are experiencing and a copy of your sales receipt or other proof of purchase in order to validate warranty status.

MODEL GS906CT