



**GLASS BOWL CHOPPER  
INSTRUCTION MANUAL  
MODEL GS701CT**

# **IMPORTANT SAFEGUARDS**

**When using electrical appliances, basic safety precautions should be followed as follows:**

- Read all the instructions.
- Intended for household use only.
- Do not use the appliance for anything other than intended use.
- Do not operate this unit in the presence of explosives and/or flammable fumes.
- Remove the unit and the instruction manual from the box and remove all packing materials.
- Do not leave the appliance unattended during operation. Close supervision is necessary when any appliance is used by or near children to avoid injury to themselves or others.
- Do not operate any appliance with a damaged cord or plug, or after the appliance malfunctions or has been damaged in any manner.
- Do not place the unit on or near gas or electric cooktops or in a heated oven to avoid damage.
- Use only replacement parts provided by the manufacturer.
- To protect against electrical shock, do not immerse power cord, plugs, or the whole unit in water or any other liquid.
- Always unplug from the wall outlet first.
- The use of an extension cord is not recommended.
- Place the unit on a level surface away from walls and cupboards. Do not let the cord hang over the edge of

a table or counter, or come into contact with hot surfaces.

- Unplug the unit when not in use and before cleaning.
- Make sure the unit is unplugged before moving the unit.
- The blades are extremely sharp, handle with care.
- Keep hands and utensils out of the chopper while in use to prevent personal injury or damage to the unit.
- The unit needs to be fully stopped before opening the lid.
- Always store blades properly to avoid damage or personal injury.
- Never chop ice in the chopper.
- Never put frozen food into the unit to avoid damaging the blade.
- Never use the chopper for longer than 2 minutes per cycle to avoid damage to the motor.
- Remove the blade first then empty the bowl of the chopper.
- Never overfill the chopper, always follow suggested capacity.
- Avoid contact with all moving parts.
- The motor needs to be securely locked in place before operating appliance. Do not attempt to remove cover until blade has stopped rotating.
- Do not use outdoors.
- SAVE THESE INSTRUCTIONS.

# PARTS IDENTIFICATION

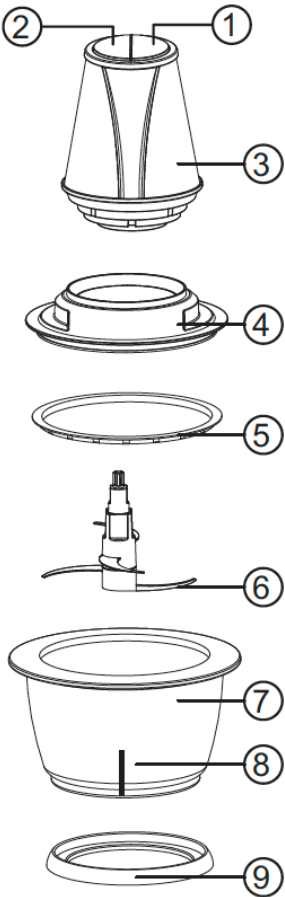

- 1.Speed II
- 2.Speed I
- 3.Motor unit
- 4.Top cover
- 5.Silicone ring
- 6.Blade
- 7.Bowl
- 8.Blade supporter
- 9.Coaster

## BEFORE FIRST USE

1. Remove all packaging materials.
2. See page 7 for care instructions and clean before use.
3. Wipe the inside and outside of the appliance with a cloth.

## USING THE APPLIANCE

### Chopping Blade:

Assembly and Use:

1. Remove the blade covers, before using.

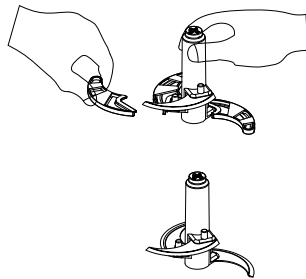

2. Place the chopping blade vertically into the blade supporter provided in the chopping bowl.  
**CAUTION:** Blades are very sharp, handle with care and always hold the plastic parts.
3. Place ingredients inside the bowl. Place the top cover in position.
4. Install the motor unit onto the chopping bowl lid and turn clockwise to lock into place. Then plug the appliance into an electrical outlet. Press either speed 1 or 2 to begin chopping, the

desired button will need to be held throughout the processing. To stop operation, release the button. Wait until the blades have stopped moving to remove ingredients.

5. After using, unplug the motor unit and turn the motor unit counter clockwise until it releases.
6. Remove the chopping blade by holding the plastic parts. Then spoon items out of the chopping bowl. **CAUTION:** The blades are very sharp, handle with care and always hold the plastic parts.

# **CLEANING**

Clean after every use.

1. Before cleaning unplug the unit.
2. Wash all parts with hot water and dish liquid. Rinse and dry thoroughly. Do not immerse in water or place in the dishwasher.
3. Wipe the external surface of the motor with a soft damp cloth and dry surfaces with soft dry cloth. Do not use any abrasive detergent as this may scratch the outside.

Note: Never immerse the motor housing in water.

# MAX AMOUNTS

Type of Vegetable	Example	Max Amount	Directions
Soft Vegetables	Celery, Onion	0.5 pounds	Chop 8-10 times
Hard Vegetables	Potato, Carrot	0.5 pounds	Press speed II 2-3 times, then chop 8-12 seconds
Meat & Vegetables	Pork, Onion	1.1 pound	Press speed II 2-3 times, then chop 12-15 seconds

# TROUBLE SHOOTING

Problem	Solution
Machine does not work	<ul style="list-style-type: none"> <li>- Check and ensure that the motor unit is properly connected.</li> <li>- Check and ensure that the appliance is properly connected to the wall outlet and that power is switched on at the outlet.</li> </ul>
Vegetables are inconsistent size after chopping.	<ul style="list-style-type: none"> <li>- Make sure to cut vegetables into similar sized chunks before adding them to the chopping bowl for processing.</li> </ul>









# LIMITED ONE YEAR WARRANTY

This warranty covers all defects in workmanship or materials in the mechanical and electrical parts arising under normal use and care in this product for a period of 12 months from the date of purchase provided you are able to present a valid proof-of-purchase. A valid proof-of-purchase is a receipt specifying item, date purchased, and cost of item. A gift receipt showing item and date of purchase is an acceptable proof-of-purchase. Product is intended for household use only. Any commercial use voids the warranty.

This warranty covers the original retail purchaser or gift recipient. During the applicable warranty period within normal household use, we will repair or replace, at our discretion, any mechanical or electrical part which proves defective, or replace unit with a comparable model. Shipping and handling costs are not included for warranty replacements and are the responsibility of the customer.

To obtain service under the terms of this warranty, call our customer care department at 312-526-3760 (Monday- Friday 10:00AM-4:00PM CST), or send an email to [customercare@alliedrich.net](mailto:customercare@alliedrich.net). Please provide the model number listed on the bottom of this page when contacting us.

## THIS LIMITED WARRANTY COVERS UNITS PURCHASED AND USED WITHIN THE UNITED STATES AND DOES NOT COVER:

- Damages from improper installation.
- Damages in transit.
- Defects other than manufacturing defects.
- Damages from misuse, abuse, accident, alteration, lack of proper care and maintenance, or incorrect current or voltage.
- Damage from service by other than authorized dealer or service center.
- Shipping and handling costs.
- This warranty gives you special legal rights and you may also have other rights to which you are entitled which may vary from state to state.

Manufacturer does not assume responsibility for loss or damage for return shipment. We recommend that you keep your original packaging should you require repair service. Before returning product please contact our customer care department for return authorization. When returning product for repair please include your full name, return address, and daytime phone number. Also include a brief description of the problem you are experiencing and a copy of your sales receipt or other proof of purchase in order to validate warranty status.

## MODEL GS701CT