

90 Day Limited Warranty

Course Housewares, LLC warrants this product to be free from manufacturer defect for up to 90 days from the original date of purchase. If a defect is found to exist, Course Housewares will, at its option, either repair or replace the product or the defective component, including labor. Replacement will be made with new or rebuilt product or components. This warranty does NOT cover (a) ordinary wear and tear (such as scratches, dents or stains), (b) impact damage or breakage, (c) heat discoloration, minor imperfections and slight color variations which are a normal part of the craftsmanship, (d) improper cleaning methods causing scratches, or (e) any unit that has been tampered with, (f) damages incurred through improper use and care and (g) faulty packaging by you or mishandling by any common carrier. Failure to follow the accompanying Care and Use instructions or commercial use will void this warranty.

Course Housewares' sole obligation and your exclusive remedy under this warranty is limited to repair or replacement, at its option, of the defective item. You will be responsible for any shipping and handling fees. Products returned to us that are not found to be defective in material or workmanship will be returned to you. If your particular product is found defective but is no longer available and cannot be repaired, a comparable product, at our discretion, will be sent as a replacement. This warranty extends only to the product's original purchaser, US residents only and does not cover damage caused by improper use or accidental damage.

COURSE HOUSEWARES, LLC., MAKES NO OTHER WARRANTIES, EITHER EXPRESSED OR IMPLIED, REGARDING THE PRODUCT OR RELATING TO ITS QUALITY, PERFORMANCE, MERCHANTABILITY, OR FITNESS FOR A PARTICULAR PURPOSE, COURSE HOUSEWARES, LLC SHALL NOT BE LIABLE FOR INDIRECT, CONSEQUENTIAL OR SPECIAL DAMAGES WHETHER A CLAIM BASED ON CONTRACT, TORT, WARRANTY OR OTHERWISE, IN NO EVENT WILL LIABILITY EXCEED THE ORIGINAL PURCHASE PRICE OF THE PRODUCT. THE DURATION OF ANY IMPLIED WARRANTY WHATSOEVER, INCLUDING BUT NOT LIMITED TO THE WARRANTIES OF MERCHANTABILITY AND FITNESS FOR A PARTICULAR PURPOSE, SHALL BE LIMITED TO THE DURATION OF THE EXPRESS WARRANTY PROVIDED HEREIN. COURSE HOUSEWARES SHALL NOT BE LIABLE FOR ANY INCIDENTAL OR CONSEQUENTIAL DAMAGES WHATSOEVER.

Some states do not allow limitations on how long an implied warranty lasts or the exclusion or limitation of incidental or consequential damages, so the above limitation or exclusion may not apply to you. This warranty gives you specific legal rights, and you may have other legal rights, which vary from State to State.

To Process a claim:

Do not return the product to the retailer from which it was purchased. Your retailer has no liability for this warranty. Please contact Course Housewares' customer service department for assistance and to ensure the fastest possible resolution to the problem. Please have your purchase information available to speed this process.

OR

Send your name, physical address, phone number, original purchase receipt and the safely packaged item prepaid to:

Course Housewares, LLC
1715 Lake Drive West
Chanhassen, MN 55317

Customer Service: Phone: (866) 325-1659 or Email: askcourse@course-h.com

Return shipping and handling charges may apply.

MADE IN CHINA
MODEL# B418047

Wine Aerator



Thank you for purchasing the Wine Aerator. The Wine Aerator will perform best when used as intended. To ensure the best performance, please consistently follow these instructions.

YOUR WINE AERATOR INCLUDES:

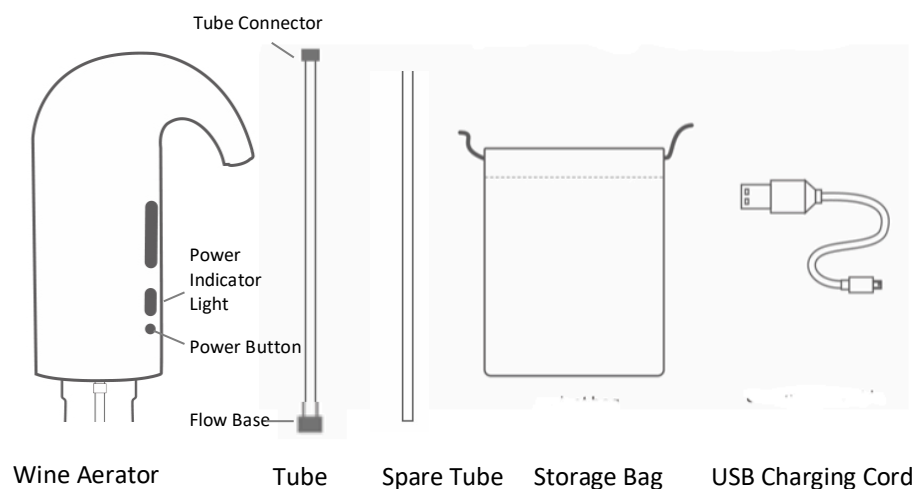

GETTING STARTED

- ◆ Before using, remove any labels and wash and dry each item in accordance with the care and use instructions.

CHARGING YOUR WINE AERATOR

- ◆ To charge your unit, plug the micro USB end of the included charging cord into the micro USB charging end of the aerator.
- ◆ The USB end of the included cord should be plugged into your desired USB compatible device.

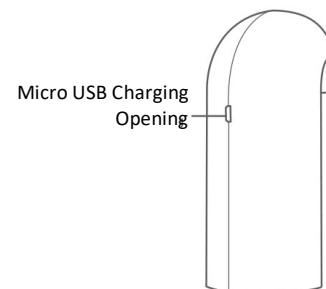

- ◆ If the bottom power indicator light turns yellow, this means the unit's charge is below 60%. It is recommended to charge at this point. If the power indicator is red, the unit's charge is below 30%. Please plug in your unit to charge. You will notice the light flashing as it's charging. Once the unit is fully charged, the power indicator will show a solid green light. Charging time from empty to full is approximately 5 hours.
- ◆ Your fully charged wine aerator will have approximately 120-240 minutes of use.
- ◆ Wait until the wine aerator has completely powered down with no indicator lights on before plugging in to charge.

CLEANING YOUR WINE AERATOR

- ◆ To clean the outside of the unit, simply wipe off with a clean, damp towel.
- ◆ With the tube connected, place the tube into a clean water source. Turn the wine aerator on and push clean water through the unit until the water becomes clear.
- ◆ Let items air dry and store in the included storage bag. Be sure that all items are completely dry before storing.

USING YOUR WINE AERATOR

- ◆ Begin by connecting the aerator tube connector into tube connection receiving area of the wine aerator. Please note your connection is a pressure fit; only slight pressure is needed to connect the tube. If unable to remove connector, insert dull utensil or tool and apply downward pressure between connector and receiver.

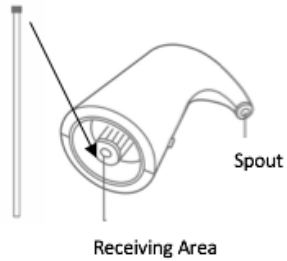

- ◆ Once the tube is connected, slowly place the flow end of the tube into an open bottle of wine. Place the wine aerator on top of the open bottle of wine. We recommend to hold the wine aerator in place when in use.

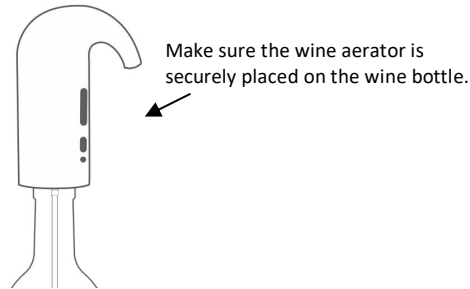

- ◆ Once the wine aerator is placed on the wine bottle, you can press the white power button to begin the aeration process. Be sure you have a glass placed under the spout for the wine to go into. Your wine aerator uses a magnet and red light process to aerate the wine. Once your glass is filled as desired, hit the white power button again to turn the wine aerator off. The unit goes into a standby mode, and unless the button is pressed again, the lights will turn off after approximately 3 minutes.

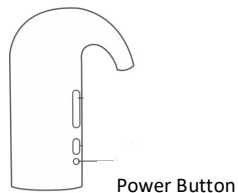

TUBE REMOVAL

- ◆ As your connection is a pressure fit, it may become difficult to remove. If unable to remove the tube connector, insert dull utensil or tool and apply downward pressure between connector and receiver.

SPARE TUBE

- ◆ In the case your wine aerator tube is clogged or damaged, we have provided a spare tube.
- ◆ The tube connector end and flow base end can be removed from the damaged tube by simply pulling them out. Clean both connector ends and insert into either end of the spare tube.