

FOOD PROCESSING ACCESSORY SET MODEL CCMFPAC1

Grinder:

Assembly:

1. Place ingredients into the grinder cup, do not fill more than halfway.
2. Set the cover onto the mouth of the grinder cup.
3. Set the grinder onto the food processor (The blade will be upright) and turn to lock.
4. Use the pulse speed for the best results.

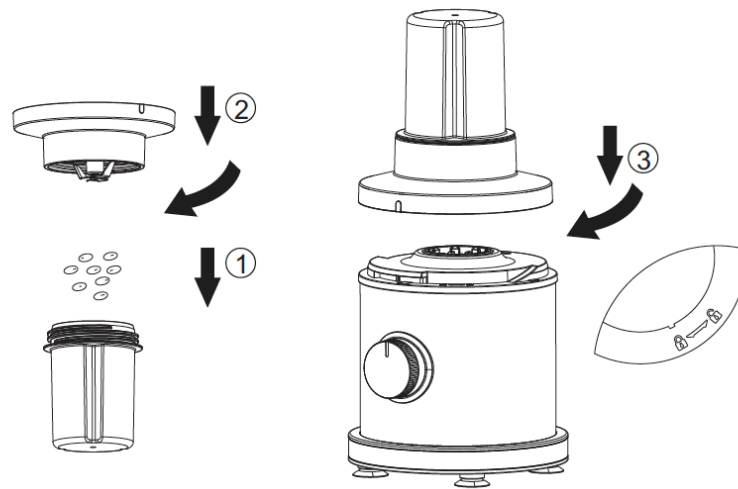

Tips: Use for milling herbs, nuts, and coffee beans.

Note: Do not use the machine for more than 1 minute at a time. For best results use the pulse speed.

Blender:

Assembly:

1. Place ingredients into the blender cup, do not fill more than halfway.
2. Set the cover onto the mouth of the blender cup.
3. Set the blender onto the food processor (The blade will be upright) and turn to lock.
4. Use the pulse speed to begin then increase the speed for the best results.

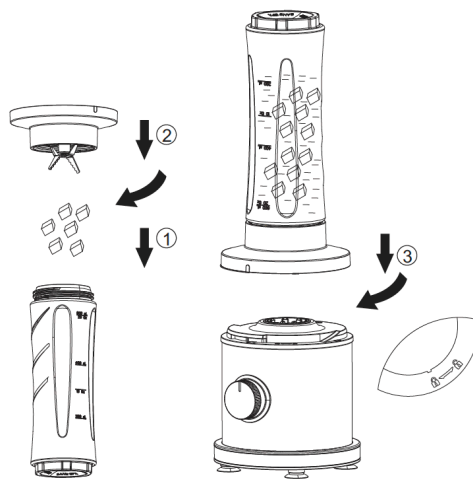

CLEANING

Clean after every use.

Before cleaning unplug the unit. Wash all parts with hot water and dish liquid. Rinse and dry thoroughly.

LIMITED ONE YEAR WARRANTY

This warranty covers all defects in workmanship or materials in the mechanical and electrical parts arising under normal use and care in this product for a period of 12 months from the date of purchase provided you are able to present a valid proof-of-purchase. A valid proof-of-purchase is a receipt specifying item, date purchased, and cost of item. A gift receipt showing item and date of purchase is an acceptable proof-of-purchase. Product is intended for household use only. Any commercial use voids the warranty.

This warranty covers the original retail purchaser or gift recipient. During the applicable warranty period within normal household use, we will repair or replace, at our discretion, any mechanical or electrical part which proves defective, or replace unit with a comparable model. Shipping and handling costs are not included for warranty replacements and are the responsibility of the customer.

To obtain service under the terms of this warranty, call our customer care department at 312-526-3760 (Monday- Friday 10:00AM-6:00PM CST), or send an email to customercare@alliedrich.net. Please provide the model number listed on the bottom of this page when contacting us.

THIS LIMITED WARRANTY COVERS UNITS PURCHASED AND USED WITHIN THE UNITED STATES AND DOES NOT COVER:

- Damages from improper installation.
- Damages in transit.
- Defects other than manufacturing defects.
- Damages from misuse, abuse, accident, alteration, lack of proper care and maintenance, or incorrect current or voltage.
- Damage from service by other than authorized dealer or service center.
- Shipping and handling costs.
- This warranty gives you special legal rights and you may also have other rights to which you are entitled which may vary from state to state.

Manufacturer does not assume responsibility for loss or damage for return shipment. We recommend that you keep your original packaging should you require repair service. Before returning product please contact our customer care department for return authorization. When returning product for repair please include your full name, return address, and daytime phone number. Also include a brief description of the problem you are experiencing and a copy of your sales receipt or other proof of purchase in order to validate warranty status.