

**Note:**

1. The locking base knob ① must be released to allow you to attach or remove the suction base ②.
2. The fruit juicer contains sharp blades, please use extreme caution when handling. Always use the pusher ⑤ to be safe.
3. Never put your fingers into the function parts.
4. Keep out of reach of children.

With proper use and care, your new juicer set should give you many great baking experiences.

Sincerely,



**LIMITED 2-YEAR WARRANTY**

This is the only express warranty for this product. Hudson Home Group, LLC., warrants this product to be free from defects in material and workmanship for single-family household use for two years from the date of original purchase. Ordinary wear and tear including damage to the blade surface is excluded. Use of product for anything other than its intended purpose is also not warranted. We exclude liability for all consequential damages. Your exclusive remedy is repair or replacement of the nonconforming product, at our option. All liability is limited to purchase price. **All other warranties, including any statutory warranty or condition of merchantability or fitness for a particular purpose, are disclaimed.** You may have legal rights that vary depending on where you live. For repair or replacement, please call with information on your product's proof of purchase and description of the problem.

Hudson Home Group LLC, Boonton, NJ 07005  
Call center : 1(855)351-8261



TODD ENGLISH

CARE & USE

**FRUIT JUICER ATTACHMENT**



# FRUIT JUICER ATTACHMENT

Dear Consumer,  
 Congratulations on your decision to purchase our high quality fruit juicer set (w/o base). With proper care, this easy to use and clean fruit juicer set should give you many years of use.  
 Please take a moment to read the use and care instructions that follow. Should you have any questions, please feel free to contact our consumer care department at ToddEnglish@hhgllc.com

## When you take it out of the package

- Wash in warm soapy water before first use.
- Dispose of packing materials in an environmentally friendly way.

## Use and Care for your fruit juicer set

- The fruit juicer set does not include suction base, please use the suction base from drum grater set.
- Make sure you clean your fruit juicer as soon as possible after use. To clean the fruit juicer, disassemble all components. Food particles that linger on your fruit juicer may congeal and become harder to remove over time.
- The fruit juicer set is NOT dishwasher safe. Please hand wash only.
- Wash with a non-abrasive sponge and detergent.
- Dry fruit juicer thoroughly with a soft cloth .
- Do not immerse the base in water.
- Make sure that your fruit juicer set is clean and dry before storage.

## The parts of Fruit juicer set w/o base

- 1 Knob for suction base
- 2 Base
- 3 Suction pad
- 4 Receiver
- 5 Pusher
- 6 Ring
- 7 Worm screw
- 8 Seal
- 9 Juicer head
- 10 Ring
- 11 Cap
- 12 Juice guider
- 13 Filter
- 14 Cup
- 15 Handle
- 16 Securing screw
- 17 Release Button

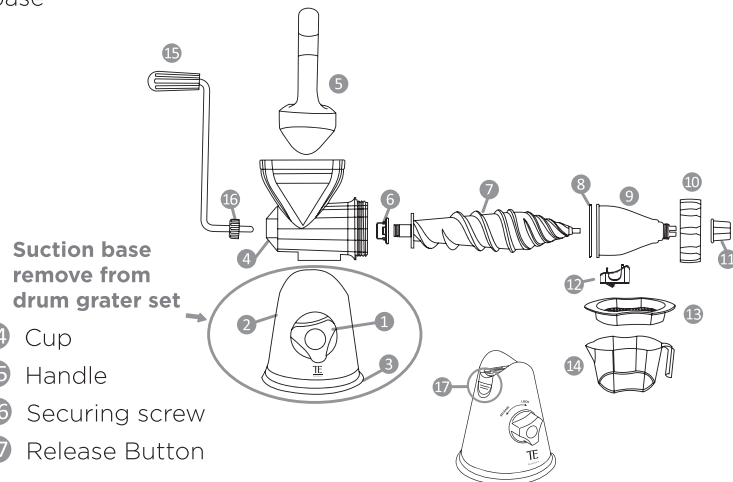

## Assembly Instructions

1. Place the ring **6** inside the receiver **4**.
2. Insert the worm screw **7** into the receiver **4** until it comes through the opening on the other side.
3. Screwing the ring **10** onto the juicer head **9**, attach the seal **8** to the juicer head **9**.
4. Attach the juicer **9** to the receiver **4**, screwing it via direction of arrow.
5. Fix the cap **11** onto the end of the juicer **9**, turning it on the direction of arrow.
6. Attach the juice guider **12** to the juicer **9** by inserting it into the appropriate holes.
7. Place the part you have just assembled onto the base **2**, sliding it to the end.
8. Assemble the handle **15** by pushing it onto the end of the worm screw **7** and lock the securing screw **16**.
9. Pressing down the release button **17** to release the function parts.

## When it's time use your fruit juicer set

1. If size of the fruit is too big to fit into the receiver, slice the fruit into small pieces first.
2. Place the filter **13** on the cup **14** and place both directly underneath the juice guider **12** for the juice, and place the container (from drum grater set or any existing one you have) underneath the end of the juicer set to fill with the coming out fruit residue.
3. Insert fruit into the receiver **4** and turn the handle **15** for juicing.
4. Use the safety pusher **5** to keep fruit in place while juicing and always keep fingers away from the worm screw.

