

90 DAY LIMITED WARRANTY

Course Housewares, LLC warrants this Cook's Companion[®] product to be free from manufacturer defect for up to 90 Days from the original date of purchase. If a defect is found to exist, Course Housewares will, at its option, either repair or replace the product or the defective component, including labor. Replacement will be made with new or rebuilt product or components. This warranty does NOT cover (a) ordinary wear and tear (such as scratches or stains), (b) impact damage or breakage, (c) heat discoloration, minor imperfections and slight color variations which are a normal part of the craftsmanship, (d) improper cleaning methods, or (e) any unit that has been tampered with, (f) damages incurred through improper use and care and (g) faulty packaging by you or mishandling by any common carrier. Failure to follow the accompanying Care and Use instructions or commercial use will void this warranty.

Course Housewares' sole obligation and your exclusive remedy under this warranty is limited to repair or replacement, at its option, of the defective product. You will be responsible for any shipping and handling fees. Products returned to us that are not found to be defective in material or workmanship will be returned to you. If your particular product is found defective but is no longer available and cannot be repaired, a comparable product, at our discretion, will be sent as a replacement. Course Housewares cannot guarantee a replacement of the same color as your original purchase. This warranty extends only to the product's original purchaser, US residents only and does not cover damage caused by improper use or accidental damage. This warranty covers the Portable Heated Electric Lunch Box only.

COURSE HOUSEWARES, LLC MAKES NO OTHER WARRANTIES, EITHER EXPRESSED OR IMPLIED, REGARDING THE PRODUCT OR RELATING TO ITS QUALITY. PERFORMANCE, MERCHANTABILITY, OR FITNESS FOR A PARTICULAR PURPOSE, COURSE HOUSEWARES, LLC SHALL NOT BE LIABLE FOR INDIRECT, CONSEQUENTIAL OR SPECIAL DAMAGES WHETHER A CLAIM IS BASED ON CONTRACT, TORT, WARRANTY OR OTHERWISE, IN NO EVENT WILL LIABILITY EXCEED THE ORIGINAL PURCHASE PRICE OF THE PRODUCT. THE DURATION OF ANY IMPLIED WARRANTY WHATSOEVER, INCLUDING BUT NOT LIMITED TO THE WARRANTIES OF MERCHANTABILITY AND FITNESS FOR A PARTICULAR PURPOSE, SHALL BE LIMITED TO THE DURATION OF THE EXPRESS WARRANTY PROVIDED HEREIN. COURSE HOUSEWARES SHALL NOT BE LIABLE FOR ANY INCIDENTAL OR CONSEQUENTIAL DAMAGES WHATSOEVER.

Some states do not allow limitations on how long an implied warranty lasts or the exclusion or limitation of incidental or consequential damages, so the above limitation or exclusion may not apply to you. This warranty gives you specific legal rights, and you may have other legal rights, which vary from State to State.

To Process a claim:

Do not return the product to the retailer from which it was purchased. Your retailer has no liability for this warranty. Please contact the Course Housewares customer service department for assistance and to ensure the fastest possible resolution to the problem. Please have your purchase information available to speed this process.

OR

Send your name, physical address, phone number, original purchase receipt and the safely packaged item prepaid to:

Course Housewares, LLC
1715 Lake Drive West
Chanhassen, MN 55317
(866) 325-1659

Return shipping and handling charges may apply.

MADE IN CHINA

MODEL: CCCSH1/ B414404

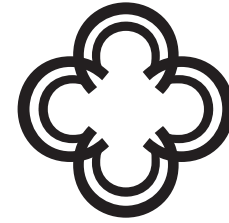

COOK'S[®] COMPANION

Portable Heated Electric Lunch Box





Thank you for purchasing Cook's Companion® Heated Electric Lunch Box. Cook's Companion® will perform best when used as intended. To ensure the best performance of your product, please consistently follow these instructions.

PLEASE READ BEFORE USE AND SAVE THESE INSTRUCTIONS

About Cook's Companion®

Exclusively available through Evine, the Cook's Companion® line sets the professional standard for quality tools offered at economic prices. Whether you're prepping meals for one, two or 20, this essential collection can cater to your any and every gastronomic need.

Cook's Companion® combines innovative and resourceful industry technologies with colorfully stylish designs. Cook's Companion® deliberately constructs each product with ease and convenience in mind. Fill your kitchen with useful products and return the joy to your kitchen with assistance from this dependable brand. Please enjoy this exclusive essential from Cook's Companion®.

Your Cook's Companion® Heated Electric Lunch Box Includes:

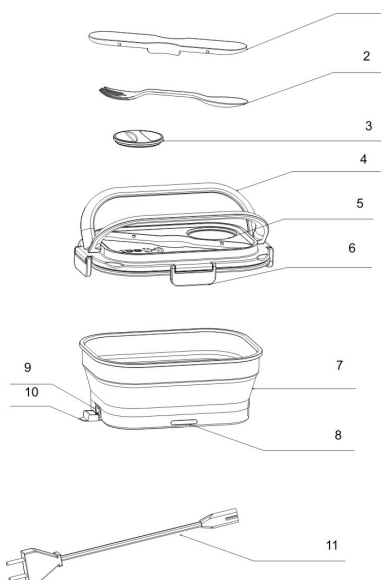

1. Spork Case
2. Spork
3. Sauce Lid
4. Handle
5. Sauce Cup
6. Lid Latch
7. Base
8. ON Light
9. Power Cord Plug In
10. Silicone Cover
11. Power Cord

IMPORTANT SAFEGUARDS:

- ◆ FOR HOUSEHOLD USE ONLY
- ◆ Read all instructions before using.
- ◆ To protect against fire, electric shock and injury, do not immerse cord, plug or unit in water or other liquids.
- ◆ Close supervision is necessary when any appliance is used near children and pets.
- ◆ Do not touch hot surfaces.
- ◆ Before use, unwind the power cord completely and keep the cord away from hot parts of the appliance.
- ◆ Do not place the unit or power cord on or near any hot surface, gas stove, electric burner, or in a heated oven or microwave.
- ◆ Only operate the unit on a dry, flat, non-slip surface.
- ◆ Do not operate the unit with a damaged cord or plug. If this product malfunctions or has been damaged in any manner, please stop operating immediately and call customer service at 1-866-325-1659 for further instruction.
- ◆ The use of any accessory not included with your product is not recommended and will void your warranty. Doing so may result in fire, electric shock, or injury.
- ◆ Always unplug from the electrical outlet when not in use and before cleaning to avoid accidental electric shock or injury.
- ◆ Allow time for the unit to completely cool before cleaning.
- ◆ As long as the appliance is hot, even if unplugged, there is danger of getting burned.
- ◆ Always use oven mitts or a towel when handling hot surfaces. Never store the unit while hot.
- ◆ Do not use the unit for anything other than its intended use.
- ◆ Extreme caution must be used when moving an appliance containing hot oil or other liquids. Always allow to cool before moving your unit or use extreme caution.
- ◆ Do not leave the unit unattended while in operation.
- ◆ Always keep the unit at least 6 inches clear from the wall and other appliances on all sides at all times when in use.
- ◆ Do not try to service the unit while it is still plugged in.
- ◆ Do not allow the cord to hang over any edge to avoid pulling, tripping, and entanglement.
- ◆ Keep these instructions in a safe place for future reference.

Getting Started

- ◆ Before using, remove any labels and wash and dry each item in accordance with the care and use instructions.

Compatibility

- ◆ The Cook's Companion® Heated Lunch Box requires a voltage of 120V or 45W, please make sure your outlet is compatible before using your product.
- ◆ The included cord should not be used with any other device besides your Heated Electric Lunch Box.

Using Your Heated Electric Lunch Box

- ◆ Your Lunch Box can be used to package cold meals, as well as food that needs reheating. Your Lunch Box is not intended to be used with uncooked food.
- ◆ Do not place the base into the fridge or freezer, as there are electrical components that could be damaged.
- ◆ To expand the Lunch Box, simply press down on the inside corners of the base until the base is completely expanded/open.
- ◆ To begin using the Lunch Box, first place your food into the base. If you are planning on heating the food, we recommend only filling to about a ½ inch from the top, this makes stirring and reheating much easier. Do not overfill the container, especially when filling with liquid or soft food.
- ◆ Once your food is in the base, line up the lid and secure the latches by pressing each latch down until it clicks and is secured to the base.

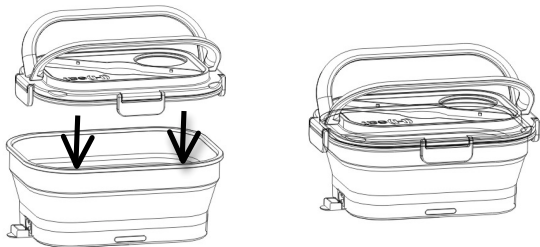

- ◆ Once the lid is secured you are ready to bring the lunch box to work, school, etc.! Your Lunch Box also has 2 built in handles on the lid portion. Always ensure the lid is fully secured before using the handles and use caution when transferring food, especially when hot.
- ◆ Your Lunch Box uses a “Slow and Low” style of reheating. Most foods will take about 1 hour to fully heat up, so we recommend plugging in the Lunch Box well in advance to ensure your food is properly heated.
- ◆ We do not recommend leaving the unit plugged in for longer than 5-6 hours at a time.
- ◆ To close the Lunch Box, first empty out all of the food contents and wipe the interior of the base (or see cleaning section of this booklet). Then, press the corners on the exterior of the base inwards until the base is fully collapsed.

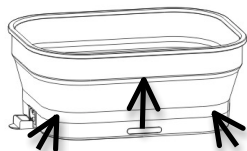

- ◆ For even better even heating and to reduce heat up time, we recommend stirring the contents every 30 minutes or so. This is not required and is only a suggestion for best heating results.
- ◆ Once the food has reached your desired temperature, first unplug the unit and then you are ready to enjoy your meal directly from your Lunch Box!
- ◆ PLEASE NOTE: You may notice the silicone rise slightly on the bottom interior of the base after heating; this is normal due to the craftsmanship of the unit and does not affect the functionality or safety of the unit itself.
- ◆ Always let the Lunch Box cool completely before collapsing or storing.

How to Heat

- ◆ To begin heating your food, you will need to plug the adaptor into the lunch box. First, open the silicone cover to do so.
- ◆ Once the adaptor is connected to the Lunch Box, plug the cord into a compatible outlet (see Compatibility section for requirements). Once the unit is plugged in, the ON Light will be lit.



Your Sauce Cup

- ◆ On the top of the lid there is a sauce cup for dressing, butter, and more!
- ◆ Your sauce cup will also heat up slightly when heating your food.
- ◆ To open the silicone lid press one side inwards slightly and then pull the handle up on the silicone lid. Please note, removing the sauce cup lid may be slightly tough the first few times.
- ◆ To place the lid onto the sauce cup simply press into place.

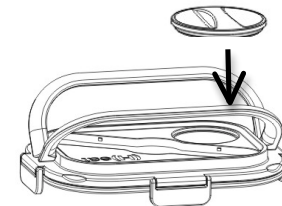

Your Spork & Spork Case

- ◆ Your included Spork comes with it's own carrying case and storing area on top of the lid . To use the Spork, simply remove the spork case from the lid and pop the spork out of the case. To replace, simply reverse the steps we listed to remove the spork & case.

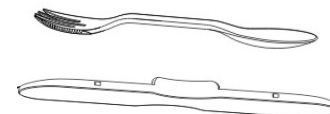

- ◆ The Spork is a multi-use utensil that includes a serrated edge (knife), spoon and a fork.

Cleaning

- ◆ The Base of your Lunch Box should never be submerged in water or other liquid.
- ◆ Only the lid, spork, spork case, and the sauce lid can be submerged in water, when not attached to the body.
- ◆ Always unplug the base and allow it to cool before cleaning and cover the AC port with the silicone cover.
- ◆ To clean the base, first remove the lid and empty any remaining food contents. Fill the base with warm soapy water to loosen any other food remains. Never use abrasive cleaners.
- ◆ Next, dump out the water and then, using a damp cloth or sponge, remove any residue in the base.
- ◆ For a deep cleaning to remove stains or water spots, use a non-abrasive cleaner or vinegar and a soft cloth.
- ◆ Always wipe the base dry before collapsing or storing, and never collapse the unit with contents inside.
- ◆ All other parts, except the base and the cord, are dishwasher safe when placed on the top rack.
- ◆ While the lids, spork, and spork case are dishwasher safe, we recommend hand washing with warm soapy water.